

Address : Unit 503, Area 2, Building 1, ABP Group City, No.537 Panyu Avenue,
Donghuan Street, Panyu District,Guangzhou, China.

Postal Code : 511400

Telephone No. : 86-20-3106 5003

Mobile No. : 86-1372 4122 257

Website : www.gztitan.com

Email : sales@gztitan.com sales@titanmanufacturer.com

地 址：广东省广州市番禺区市桥东环街番山创业中心1号楼二区503室

邮 编：511400

电 话：86-20-3106 5003

手 机：86-1372 4122 257

网 站：www.gztitan.com

邮 箱：sales@gztitan.com sales@titanmanufacturer.com



广州泰堂建材有限公司
GUANGZHOU TITAN BUILDING MATERIALS CO., LTD.



Product Presentation

TITAN Gypsum Board is often called drywall, wallboard, or plasterboard, the main materials are pure gypsum powder, quality wood-pulp paper and adhesive and so on. It differs from other panel-type building products, such as plywood, hardboard, and fiberboard, because of its noncombustible core and paper facers. When joints and fastener heads are covered with a joint compound system, gypsum wall board creates a continuous surface suitable for most types of interior decoration. There are Regular, Fire Resistant, Moisture Resistant and Water Resistant series.

Plasterboard Range



Regular Plasterboard



Fire Resistant Plasterboard



Moisture Resistant Plasterboard
Water Resistant Plasterboard

Item	Edge	Length(mm)	Width(mm)	Thickness(mm)
Regular	TE / SE	1830/2400/2440/3600	1200/1220	9/9.5/10/11/12/12.5/12.7/13/15/15.9
Fire Resistant	TE / SE	1830/2400/2440/3600	1200/1220	9.5/12/12.5/12.7/15
Moisture Resistant	TE / SE	1830/2400/2440/3600	1200/1220	9.5/10/12/12.5/12.7/15
Water Resistant	TE / SE	1830/2400/2440/3600	1200/1220	9.5/10/12/12.5/12.7/15

Technical Parameters

Item	Standard Value	Test Value			
		Thickness	Regular	Fire Resistant	Water Resistant
Density (kg / m ²)	≥9.5 kg / m ²	9.5 mm	7.5	7.5	9.2
	≥12.0 kg / m ²	12 mm	9.5	9.5	11.5
Flexural Strength (N)	≤360	9.5 mm	560		
	≤500	12 mm	700		
	≤140	9.5 mm	180		
	≤180	12 mm	240		
Surface Paper Sticking the Core Materials	Unexposed	Unexposed			
Stability with Fire (Min)	Fire Resistant	≤20	/	/	>20
Water Absorption (%)	Water Resistant	9.5 mm	/	/	6.8
		12 mm	/	/	4.2
Radioactivity	Internal	IRa≤1.0	<0.1		
	External	Ir ≤ 1.3	<0.1		
Note	Executive Standard: GB / T9775-2008				

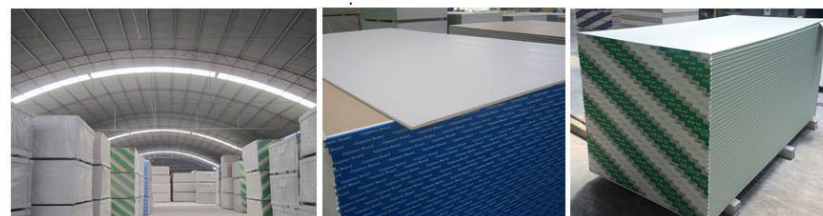

Application

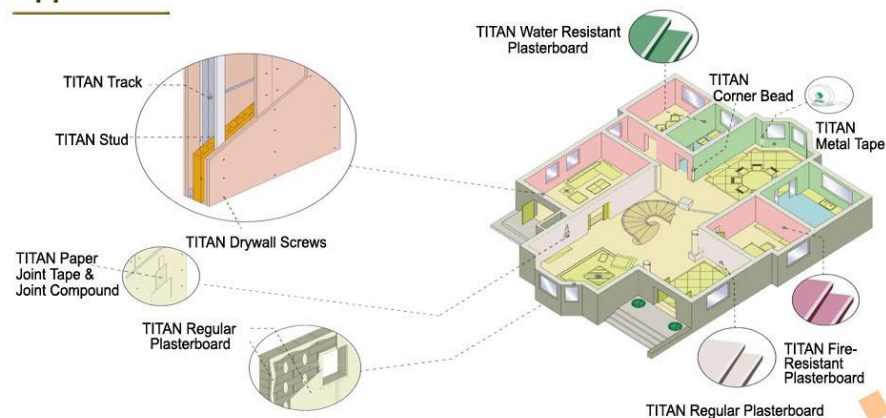

Wall Systems

No.	Items	Overview	Specification	Unit	Dosage
1	Gypsum Board		1200 × 2400 × 12mm	M ²	1
2	Metal Track		QU75 × 35 × 0.5mm	M	1 ~ 1.4
3	Metal Stud		QC75 × 45 × 0.5mm	M	2.2 ~ 3.6
4	Intermediate Channel		DU38 × 12 × 0.6mm	M	1 ~ 1.4
5	Corner Bead		25 × 25 × 0.4mm	PCS	0.6
6	Supporter		# 75	PCS	1
7	Drywall Screw		3.5 × 35mm	PCS	25 ~ 30
8	Paper Joint Tape Mesh Tape		Paper: 4.7cm × 75m Paper: 5cm × 90m	M	1
9	Joint Compound		20 kgs / bag	KGS	0.5
10	Ready Mixed Wall Putty		25 kgs / buckets	KGS	2

Single Layer with Single C-Stud

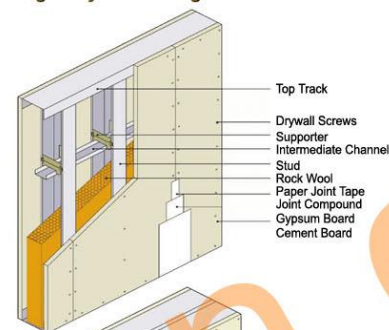

Double Layers with Single C-Stud

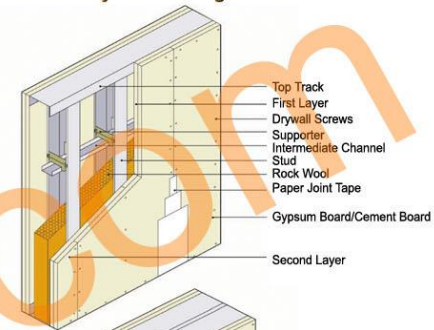

Single Layer with Double C-Stud

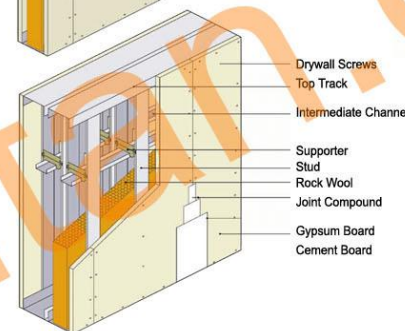

Double Layers with Double C-Stud

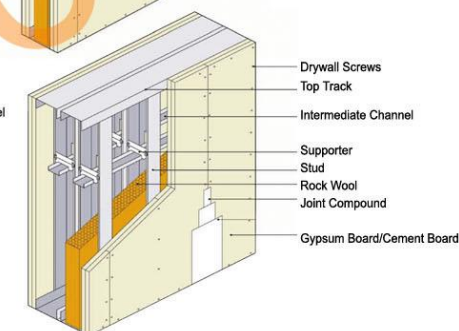

1. Sealant



2. Top Track



3. Stud



4. Fixed Stud & Track



5. Intermediate Channel



6. Supporter



7. Fixed Gypsum Board



8. Jointing

Ceiling Systems

No.	Items	Overview	Specification	Unit	Dosage
1	Gypsum Board		1200 × 2400 × 9/9.5mm	M ²	1
2	Furring Channel		35 × 22 × 0.5mm	M	3
3	Main Channel		DU38 × 12 × 0.8mm	M	1
4	Wall Angle		25 × 25 × 0.5mm	M	0.6
5	Connector		# 38	PCS	0.5
6	Hanger		# 38	PCS	1.2
7	Furring Channel Clip		# 38	PCS	6
8	Thread Rod		Φ6 / Φ8	PCS	1.2
9	Sleeve Anchor		Φ6 / Φ8	PCS	1.2
10	Bolt Screw		Φ6 / Φ8	SETS	1.2
11	Nut		Φ6 / Φ8	PCS	4.8
12	Drywall Screw		3.5 × 25mm	PCS	25 ~ 30
13	Paper Joint Tape		4.7cm × 75m	M	1 ~ 2
14	Joint Compound		20 kgs / bag	KGS	0.5

Furring Channel for Ceiling

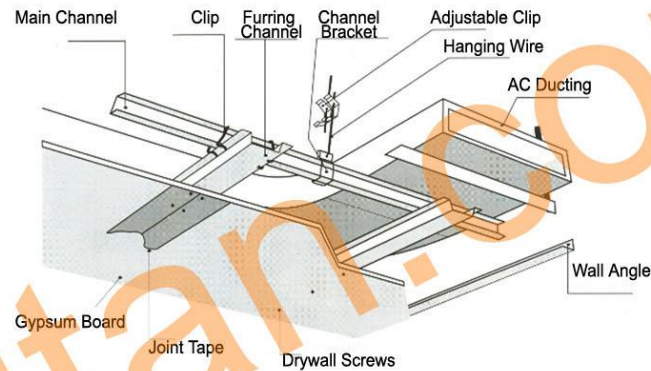

Suspended Bar for Ceiling

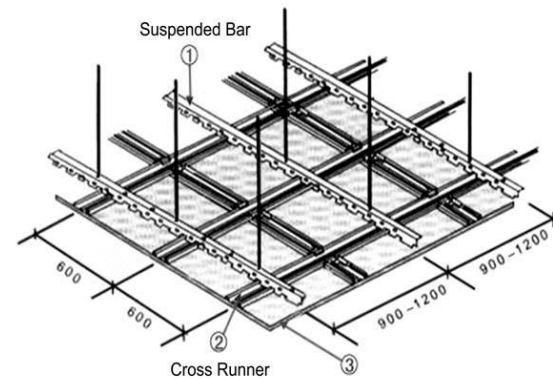

Metal Profiles

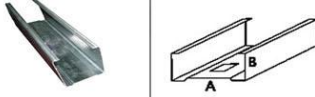

Metal Stud			
Width A (mm)	Height B (mm)	Length (mm)	Thickness (mm)
50	40	3000	0.4/0.45/0.5/0.6
65	35	3000	0.4/0.45/0.5/0.6
70	35	3000	0.4/0.5/0.6
70	40	3000	0.4/0.5/0.6
75	35	3000	0.4/0.45/0.6
75	45	3000	0.4/0.5/0.6
100	50	3000	0.6/0.7/0.8/1.0

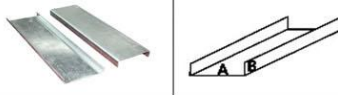

Main Runner			
Width A (mm)	Height B (mm)	Length (mm)	Thickness (mm)
38	12	3000	0.7/0.8/1.0/1.2
50	15	3000	0.8/1.0/1.2
60	27	3000	0.8/1.0/1.2



Suspended Bar			
Width A (mm)	Height B (mm)	Length (mm)	Thickness (mm)
20	25	3000	
20	28	3000	0.6/0.7/0.8/0.9/1.0
20	32	3000	



Furring Channel				
A	C	Height B (mm)	Length (mm)	Thickness (mm)
35	13	22	3000	0.4/0.5

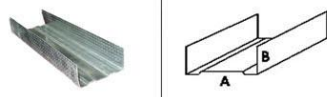

Metal Track			
Width A (mm)	Height B (mm)	Length (mm)	Thickness (mm)
50	40	3000	0.4/0.5/0.6
65	30	3000	0.4/0.45/0.5/0.6
70	30	3000	0.4/0.45/0.5/0.6
70	35	3000	0.4/0.45/0.5/0.6
75	25	3000	0.4/0.45/0.6
75	35	3000	0.45/0.5/0.6
100	40	3000	0.4/0.5/0.6/0.8

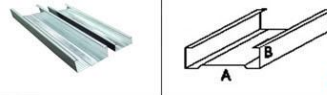

Cross Runner			
Width A (mm)	Height B (mm)	Length (mm)	Thickness (mm)
50	15	3000	0.8/1.0/1.2
50	19	3000	0.4/0.45/0.5
60	27	3000	0.4/0.5/0.6

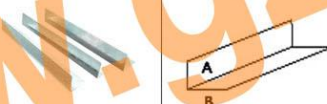

Wall Angle			
Width A (mm)	Height B (mm)	Length (mm)	Thickness (mm)
25	25	3000	0.4/0.45/0.5
30	30	3000	0.4



Corner Bead			
Width A (mm)	Height B (mm)	Length (mm)	Thickness (mm)
25	25	3000	0.4/0.45/0.5

Accessories

 Main Runner Connector 38 / 50 / 60	 Hanger 38 / 50 / 60	 Cross Runner Connector 50 / 60	 Leveling 50 / 60
 Connecting Clip 38 / 50 / 60	 Supporter 75 / 100	 Furring Channel Clip	 Thread Rod #6 / #8
 Sleeve Anchor #6 / #8	 Drop in Anchor #6 / #8	 Nuts #6 / #8	 Bolt #6 / #8
 Screws M3.5X25mm M3.5X35mm	 Paper Joint Tape 46mmX50m 46mmX75m	 Mesh Tape 50mmX50m 50mmX90m	 Metal Tape 50mmX30m
 Joint Compound / Wall Putty 20 kgs / bag	 Ready Mixed Joint Compound 25kgs/bucket	 Anchor #6 / #8	 Adjustable Hook Rod

Overview	Name	Head	Thread	Diameter(mm)	Length(mm)
	Drywall Self Tapping Screw	Bugle	Fine / Coarse	3.5	13
					25
					35
					45
					55
					70
	Drywall Self Drilling Screw	Bugle	Fine / Coarse	3.5	16
					25
					35
					70
	Drywall Self Drilling Screw	Flat	Fine / Coarse	3.5	25
					25
					4.2
					16
					25
	Drywall Self Drilling Screw	Pan Framing	Fine / Coarse	3.5	9.5
					11
	Head Diameter: 8 mm Shank Diameter: 3.7 mm Accessory: Flute and Angle Clip				